

PIANTA 1:20

STRALCIO PLANIMETRICO 1:100
STATO ATTUALE

SEZIONE B1-B1 1:20

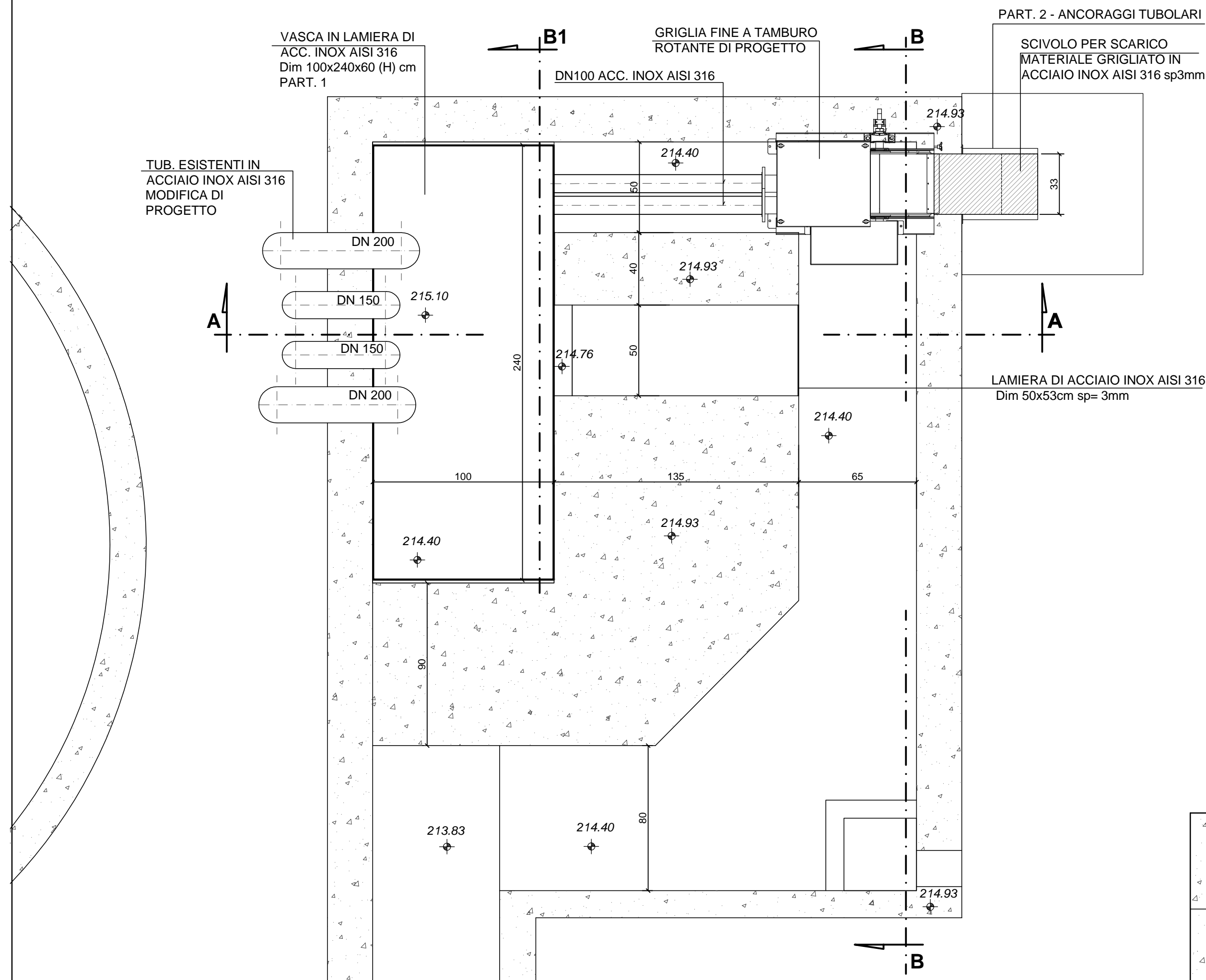
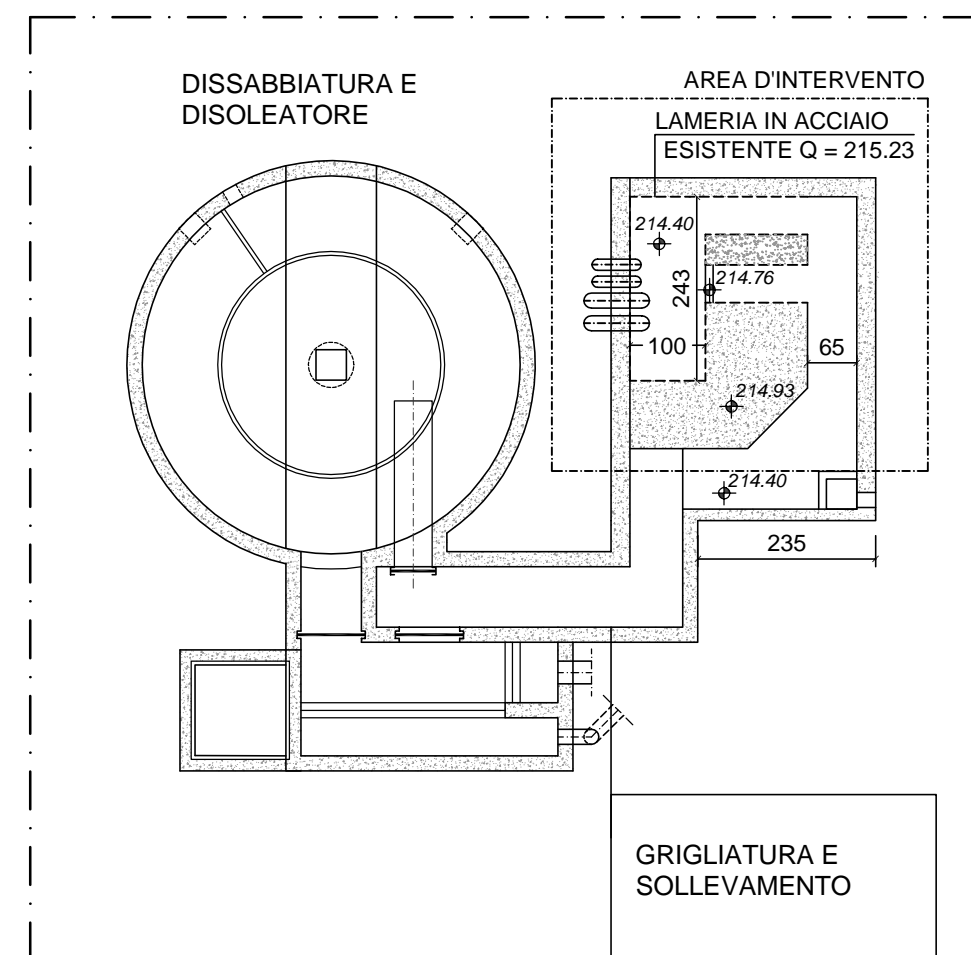
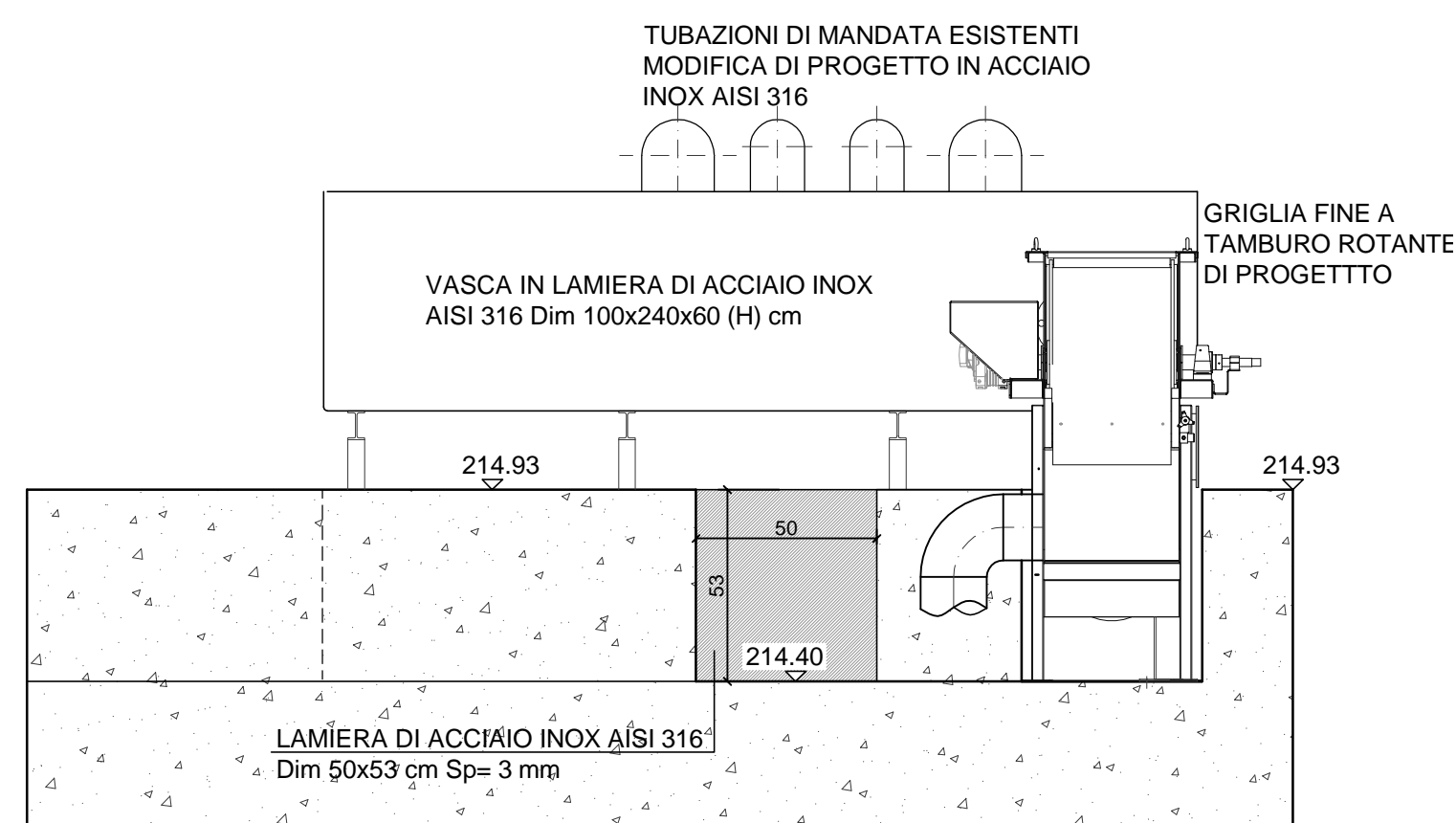

SEZIONE B-B 1:20

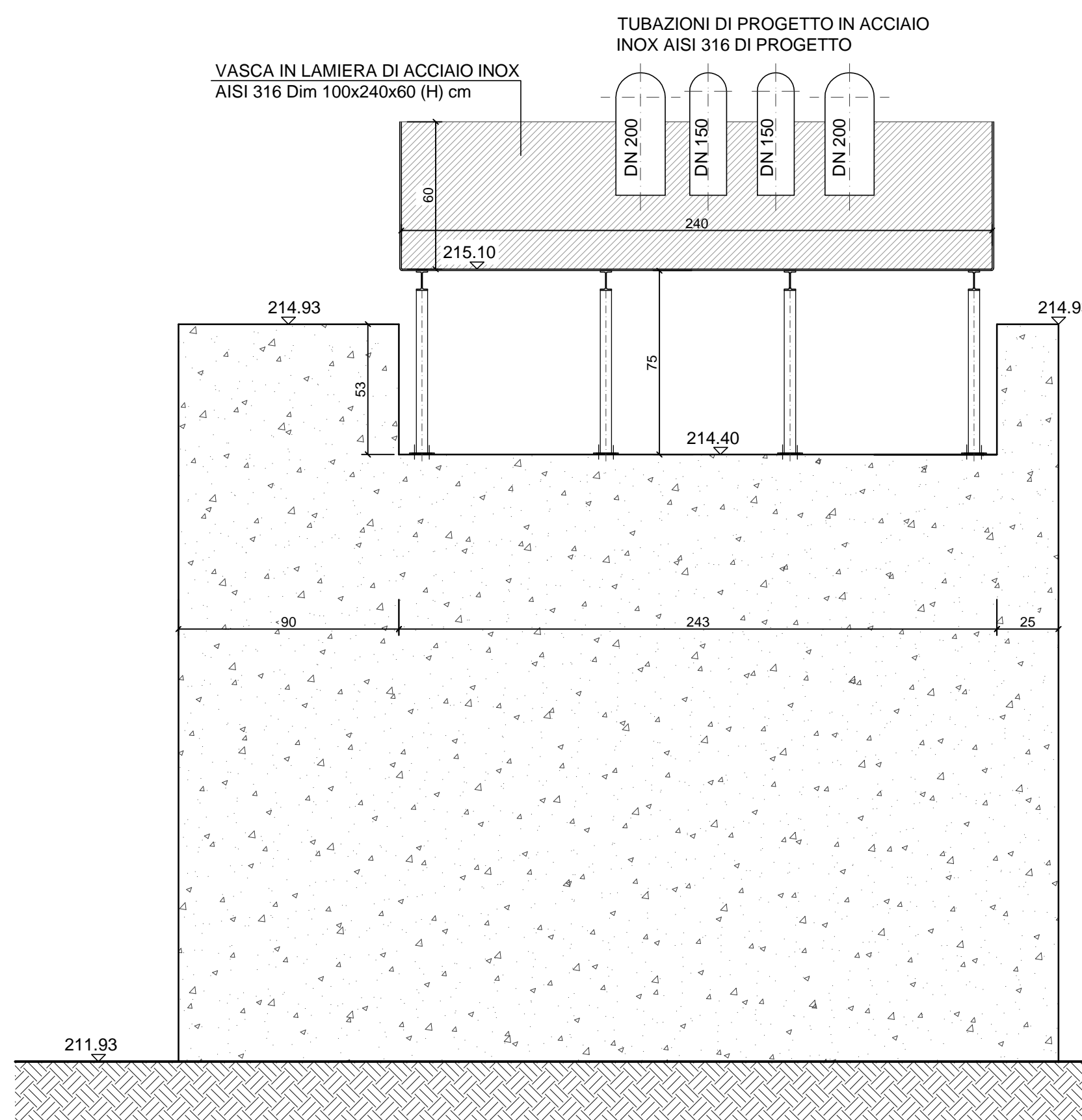

PART. 1 - VASCA 1:20

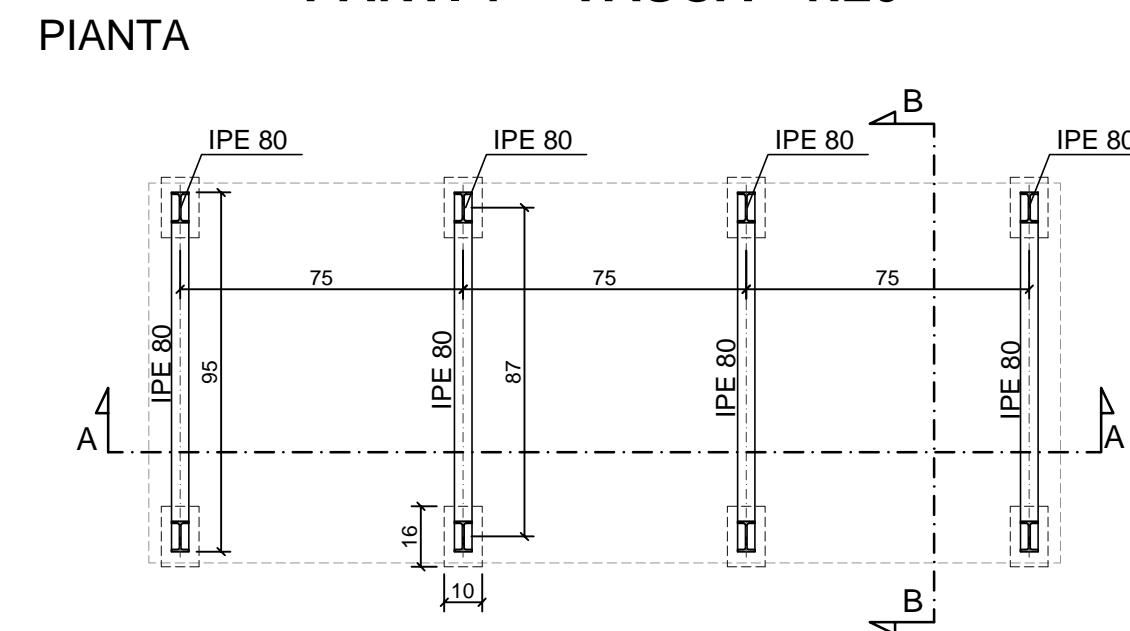

PART. 3 1:10

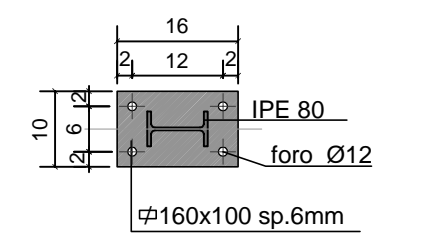

PART. 4 1:10

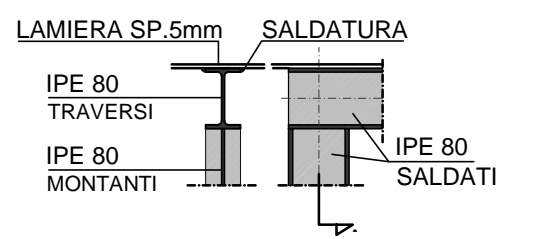

SEZIONE A-A

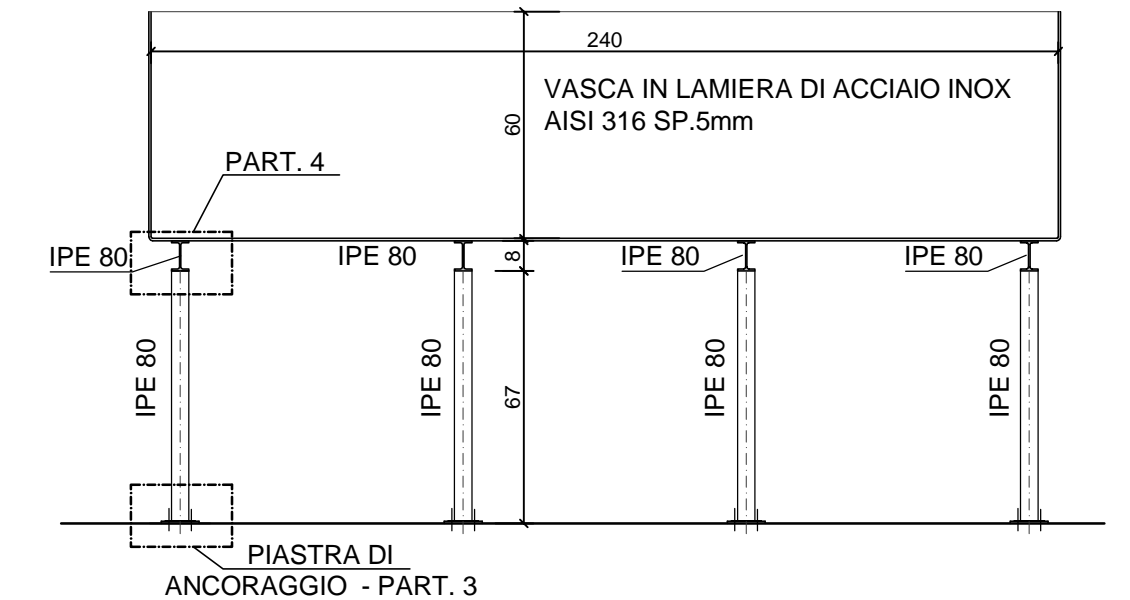

SEZIONE B-B

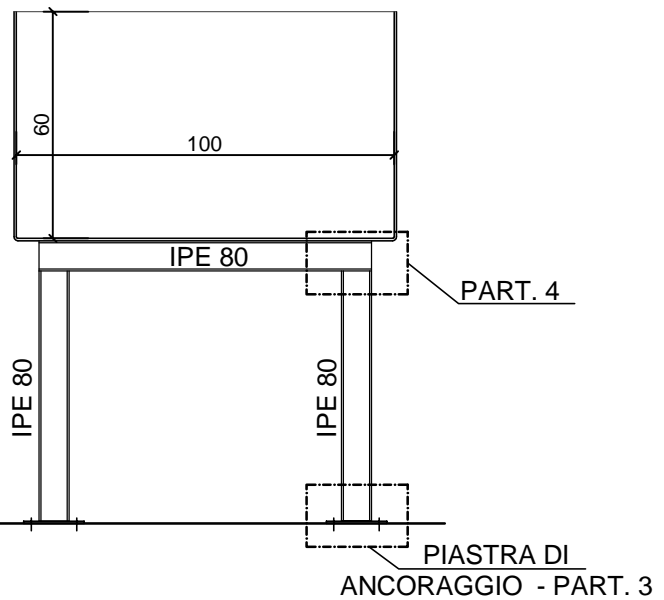

PART. 2 - ANCORAGGI SCIVOLO PER SCARICO 1:10

PIANTA

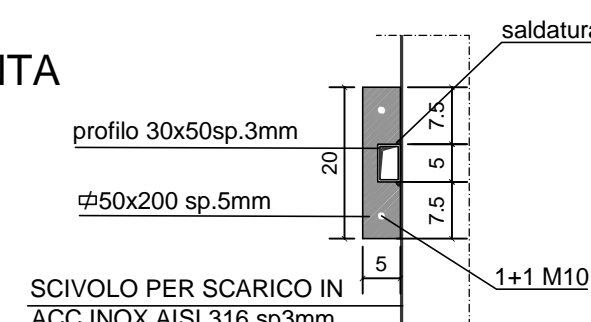

PROSPETTO

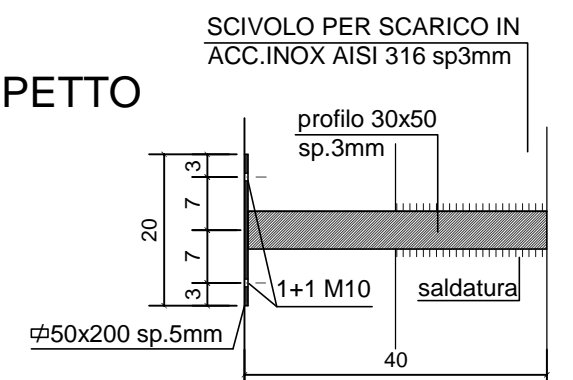

SEZIONE A-A 1:20

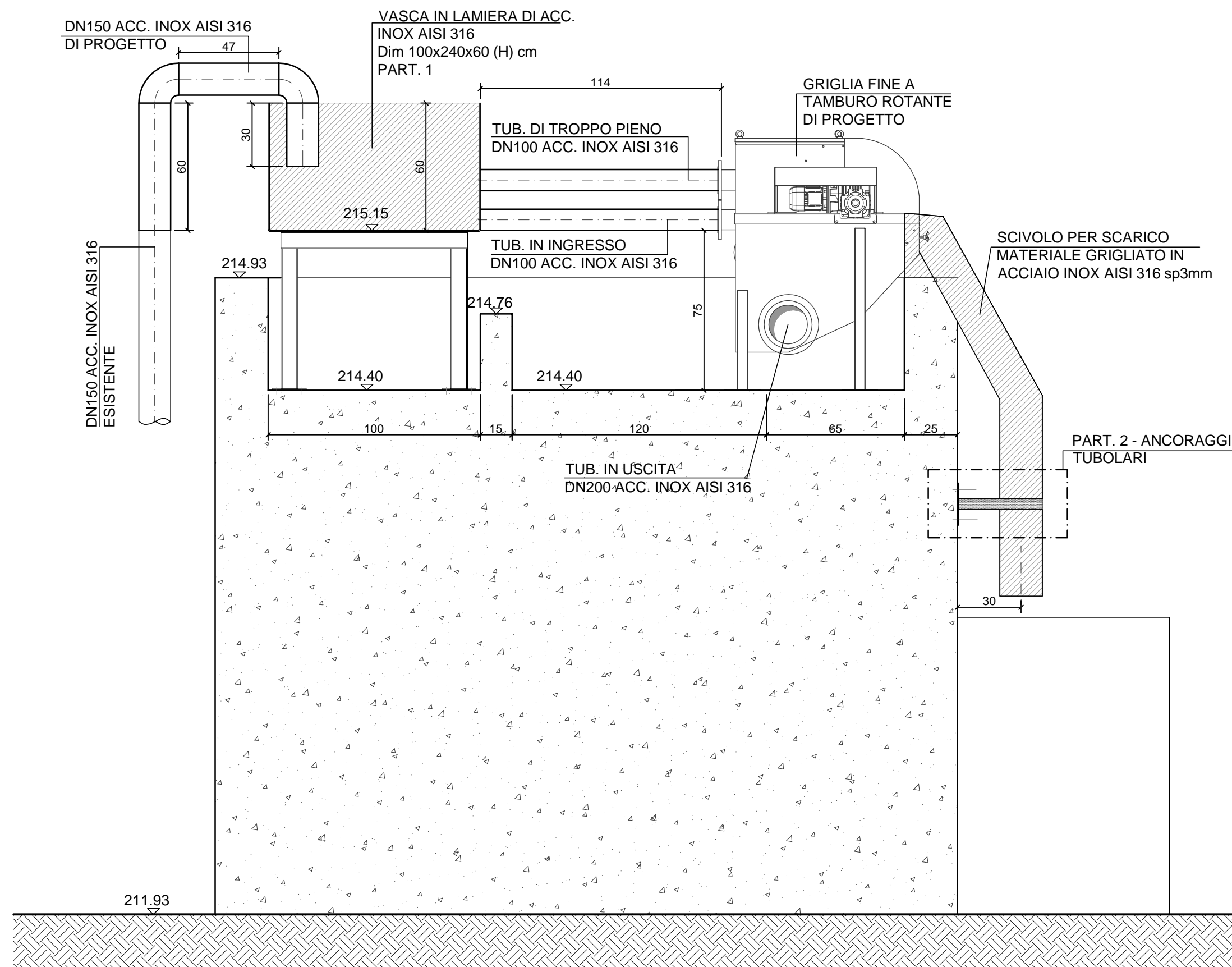

A.T.I. N°1 - A.T.I. N°2



UMBRA ACQUE S.p.A.
Via G. Benucci, 167 - 06087 Ponte San Giovanni (PG)

**RACCOLTA E DEPURAZIONE DELL'AGGLOMERATO DI
DERUTA, TORGIANO, BETTONA POTENZIAMENTO
DEPURATORE LOC. COMUNANZA
(PAR-FSC 2007-2013)**

PROGETTO DEFINITIVO

PROGETTISTA



STUDIO ASSOCIATO ATRE INGEGNERIA
Via Lucca, 12 - San Giustino V.no (AR)
Tel. 055476528 - Fax 0553986924
info@atreingegneria.net P.IVA 01932810514



DOTT. ING. LEONARDO DURANTI

INTEGRAZIONE PRESTAZIONI SPECIALISTICHE

DOTT. ING. LUISA BRACCESI

TITOLO ELABORATO

GRIGLIATURA FINE

CODICE PROGETTO

L398_S_Erasmo-Deruta

DATA

MARZO 2015

REVISIONE N.

SCALA

1:100-20-10

N. ELABORATO

07